

# HOW TO USE THE COMPASS ON THE DS-X GMT

## Northern hemisphere WITHOUT DAYLIGHT SAVING TIME

**A.** Hold the watch flat.



**B.** Align the watch's hour hand with the direction of the sun.

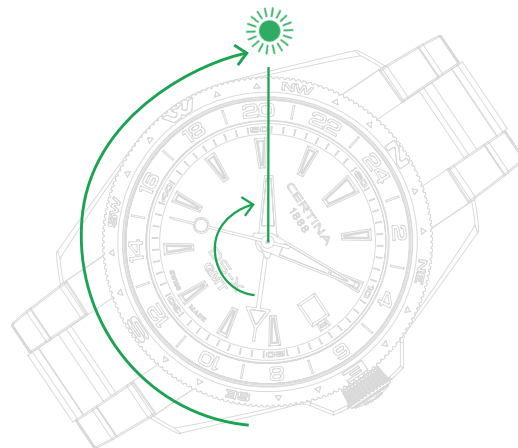

**C.** Locate south

- I. Visualise an angle between the hour hand and the 12 o'clock mark.
- II. If it is morning, visualise an angle between the hour hand and 12 o'clock going clockwise. If it is afternoon/evening, visualise an angle between the hour hand and 12 o'clock going anti-clockwise.
- III. South is located at the midpoint of this angle, i.e. halfway between the hour hand and 12 o'clock.

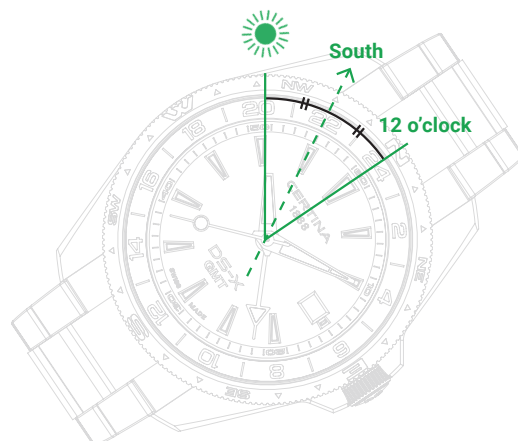

**D. Rotate the bezel**

- I. Turn the bezel so the "S" (south) aligns with this midpoint.
- II. Now the bezel shows the cardinal directions.

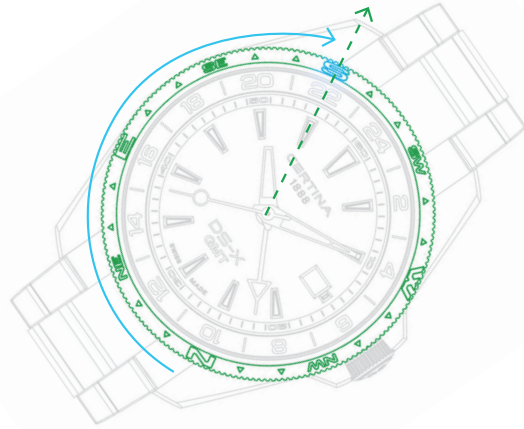

---

## Northern hemisphere WITH DAYLIGHT SAVING TIME

- C.** Method as above, but at step C, visualise an angle between the hour hand and 1 o'clock (rather than 12 o'clock).

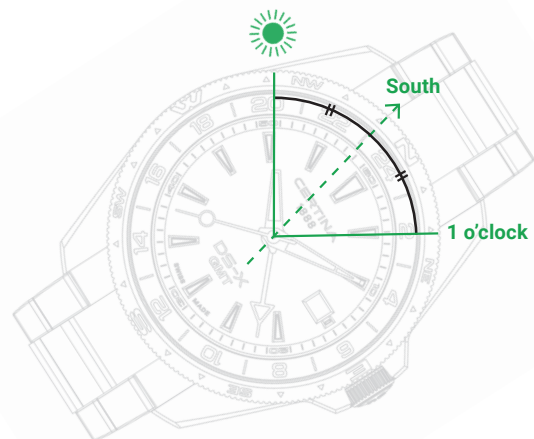

**D. Rotate the bezel**

- I. Turn the bezel so the "S" (south) aligns with this midpoint.
- II. Now the bezel shows the cardinal directions.

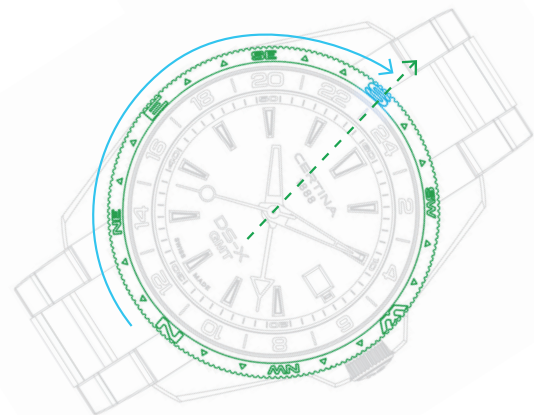

# HOW TO USE THE COMPASS ON THE DS-X GMT

## Southern hemisphere WITHOUT DAYLIGHT SAVING TIME

**A.** Hold the watch flat.



**B.** Align the 12 o'clock mark with the direction of the sun.

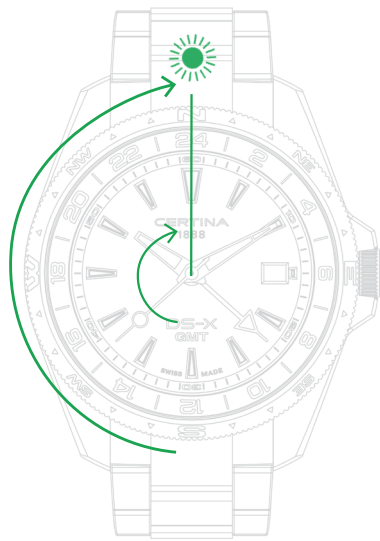

**C.** Locate north

- I.** Visualise an angle between 12 o'clock and the hour hand.
- II.** North is located at the midpoint of this angle, i.e. halfway between 12 o'clock and the hour hand.

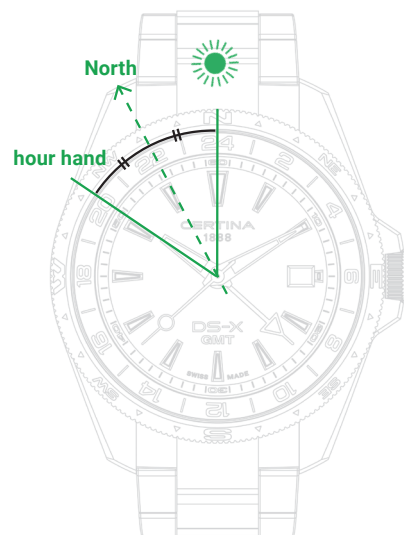

**D.** Rotate the bezel

- I.** Turn the bezel so the "N" (north) aligns with this midpoint.
- II.** Now the bezel shows the cardinal directions.

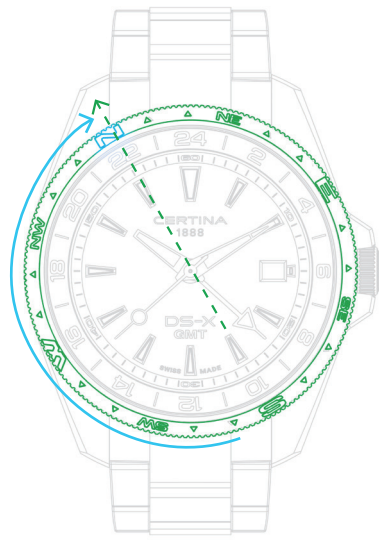

---

## Southern hemisphere WITH DAYLIGHT SAVING TIME

- C.** Method as above, but at step B, align the 1 o'clock mark with the direction of the sun (rather than the 12 o'clock mark).

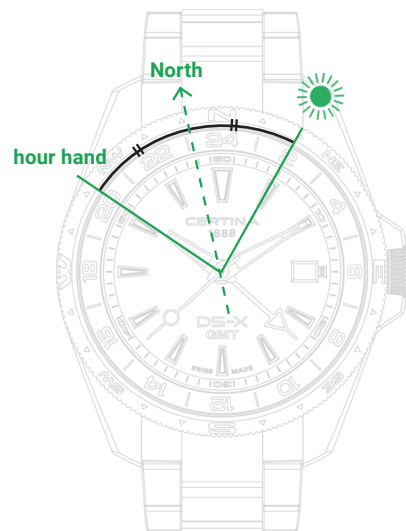

**D.** Rotate the bezel

- I.** Turn the bezel so the "N" (north) aligns with this midpoint.
- II.** Now the bezel shows the cardinal directions.

